

SPICER[®]

Drivetrain Products

HEAVY AXLE COMPONENTS



**HX500-QR
SEPTEMBER 2005**

**Supersedes
HX500-QR
Dated April 2005**



People Finding A Better Way[®]

TABLE OF CONTENTS

MODEL IDENTIFICATION 3

 Steer Axle Identification 3

 Spicer Steer Axle Nomenclature..... 3

 Drive Axle Identification 3

 Spicer Heavy Axle Nomenclature 3

SPICER HEAVY AXLE PRODUCTION KEY 4

SPICER STEER AXLE SERVICE PARTS 5

 King Pin Kits - All Models 5

 Tie Rod Assemblies/Kits (I Family) 7

 I-80 and I-100 7

 I-120, I-130, I-132, I-140 8

 I-100W, I-120W, I-140W..... 9

 Tie Rod Assemblies/Kits (D, E & EFA Families)..... 9

 D-600, D-700, D-800, D-850..... 9

 E-1000I, E-1002, E-1202I, E-1320I, E-1460I, E-1462I 10

 EFA10F4, 12F4, 13F5..... 11

 EFA18F3, 20F4, 22T2/T5, 24T2/T5 11

 Cross Tube & Tie Rod End Assemblies Cross Reference 12

DRIVE AXLE SERVICE PARTS 13

 Bearing Kits 13

 Basic Overhaul Kits 16

 Ring Gear & Pinion Sets 20

 Seals - Drive, Steer & Wheel Ends 26

 Seals - Rear Pinion Location 26

 Seals - Forward Input Location 27

 Seals - Forward Output Location..... 28

 Seals - Steer Axles - Knuckle Seal Location 28

 Seals - Wheel Ends - Hub Seal Location 28

 Dana Oil Seal Installation Tools..... 29

 Wheel Differential Case Kits 30

 Differential Case Kits..... 31

 Wheel Differential Side Gear Kits 32

 Wheel Differential Kits (less Side Gears)..... 33

 Miscellaneous Axle Kits 33

 Axle Shafts 34

 16 & 19 Spline 34

 20 Spline..... 34

 22 Spline..... 34

 33 Spline..... 35

 34 Spline..... 35

 36 Spline..... 35

 39 Spline..... 36

 41 Spline..... 37

 Dana Models D/R 404, 405, & 454 - 41 Spline 37

Service Carriers 38

TABLE OF CONTENTS

Spicer Legacy Models38
F Series39
G Series.....39
J Series39
M Series41
S Series Single Axles.....42
S Series Tandem Axles43
W Series.....43

MODEL IDENTIFICATION

Steer Axle Identification

The Spicer front non drive steering axles are identified with a tag located between the spring pads, on the front side of the center beam section.

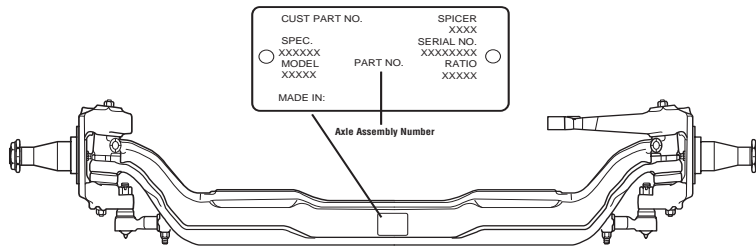

Spicer Steer Axle Nomenclature

The Spicer model numbering system provides pertinent information about the axle for easy identification. For example:

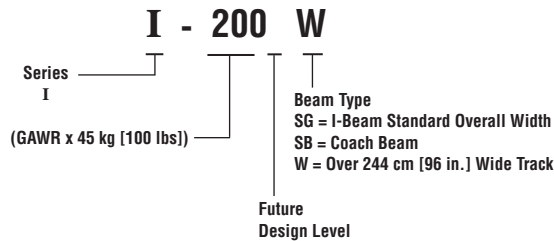

Drive Axle Identification

All Spicer heavy axle assemblies are identified with two tags. One located on the differential carrier, and the other on the right front leg of the banjo housing. The carrier tag contains the serial number, the carrier assembly number, and the ratio. The housing tag contains the serial number, model number, and the axle assembly number.

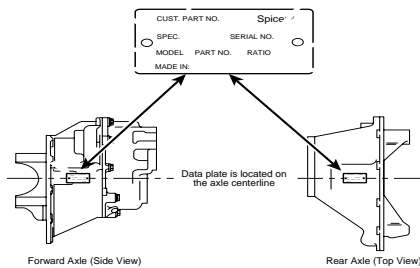

Spicer Heavy Axle Nomenclature

The Spicer Model numbering system provides pertinent information about the axle for easy identification. For example:

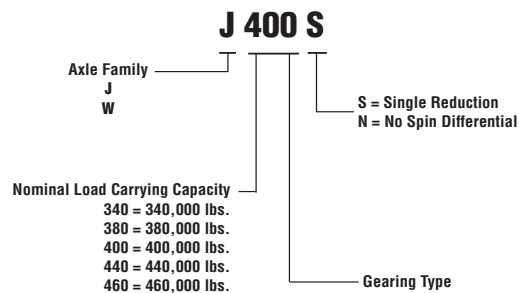

SPICER HEAVY AXLE PRODUCTION KEY

Non Drive Front Axles

Spicer Model	G.A.W.R.	Production Dates
I50	5,000	Pre 1989
I60	6,000	1989 to current
I75	7,500	Pre 1990
I80	8,000	1988 to current
I90	9,000	Pre 1990
I100	10,000	1988 to current
I108	10,800	Pre 1990
I120	12,000	Pre 1987
I132	13,500	1987 to 2002
EFA12F4	12,000	1981 to 1995
EFA13F5	13,500	1983 to 1995

Single Speed Rear Axles

Spicer Model	G.A.W.R.	Production Dates
F155	10-15,500	1987 to 1997
F170	17,000	Pre 1989
G175	17,500	Pre 1989
G190	19,000	Pre 1988
J175	17,500	1976 to 2002
J190	17,500-19,000	1976 to 2002
J210	21,000	1976 to 2003
J220	22,000	1976 to 2003
M185/M190	19,000	Pre 1987
M220	22,000	Pre 1989
S100	10,000	1994 to 1997
S122	12,200	1994 to 1997
W230*	23,000	1986 to 2004
W230SP	23,000	Pre 1986
S230SL*	23,000	1994 to 2004
S230*	23,000	1994 to 2004
S230SL*	23,000	1994 to current
21065S	21,000	1985 to 1994
21065D	21,000	1986 to 1994

Tandem Drive Axles

Spicer Model	G.A.W.R	Production
G300	30,000	Pre 1986
G340	34,000	Pre 1986
G380	38,000	Pre 1986
J340	34,000	1986 to 1990
J380	38,000	1986 to 1990
J400	40,000	1986 to 1999
S230SL/T200	40,000	1994 to 2001
S400 standard axle	40,000	1994 to 2001
S400 w/lube pump	40,000	1994 to 2001
S400 standard axle w/215 wheel	40,000	1994 to 2001
S400 w/driver cntrl. diff	40,000	1994 to 1997
S400SL w/lube pump, diff lock*	40,000	1994 to 1997
W460	46,000	1986 to 2001

Two Speed Rear Axles

Spicer Model	G.A.W.R	Production
G155T	15,500	1989 to 2002
G175T	17,500	1986 to 2002
M190T	19,000	1986 to 2004
M210T	21,000	1986 to 2004
M220T	22,000	1986 to 2004

SPICER STEER AXLE SERVICE PARTS

King Pin Kits - All Models

FEATURES:

- Spicer king pin kits include the latest genuine original design parts. Parts are designed to prevent contamination and significantly improve durability and reduce maintenance
- Kits include sealed thrust bearings that improve life and ensure durability. Easy to install Pre-sized bushings made from acetal polymer, designed to last and proven to last longer
- Optional bronze king pin bushings available for rugged or harsh off-road applications

King Pin Kits

Model	Kit Part #	Size*	Bushing Type**	Pin Type***	Pin Length	Pin Diameter
D-800F/W pre 9/18/02	101KK111	Standard	G	D.O.	8.07	1.359
D-800, 850 F/W after 9/18/02	329182	Standard	G	D.I.	8.07	1.359
E-1000, 1200, 1201, & 1320 I/W	328342	Standard	B	S	9.06	1.794
	328344	Standard	G	S	9.06	1.794
E-1202, 1322, 1462, & 1002 I/W	328347	Standard	B	D.I.	9.06	1.873
	328349	Standard	G	D.I.	9.06	1.873
E-1203I/W	328346	Standard	B	D.I.	9.06	1.794
	328348	Standard	G	D.I.	9.06	1.794
E-1460I/W after 1/1/00	328343	Standard	B	S	9.06	1.873
E-1460I/W after 1/1/00	328345	Standard	G	S	9.06	1.873
E-1460I/W pre 1/1/00	329404	Standard	G	S	9.06	1.873
E-1460I/W pre 1/1/00	329405	Standard	B	S	9.06	1.873
EFA12F3, 13F3	806356	Standard	G	S	9.12	1.625
EFA12F4, 13F5	806355	Standard	G	S	9.12	1.625
EFA18F3, EFA20F4 pre 1/1/00, EFA22T2/T5 pre 1/1/00, EFA24T2/T5 pre 1/1/00	329434	Standard	B	S	9.97	1.873
	811525	Standard	G	S	9.97	1.873
EFA20F4, EFA22T2/T5, EFA24T2/ T5 after 1/1/00	329432	Standard	G	S	9.97	1.873
EFA24T2/T5 after 1/1/00	329432	Standard	G	S	9.97	1.873
EFA24T2/T5 after 1/1/00	329433	Standard	B	S	9.97	1.873
EFA24T2/T5 pre 1/1/00	329434	Standard	B	S	9.97	1.873

KEY: *OS = Oversize **Bushing Type: B = Bronze, G = Presized Garlock *Pin Type: S = Single Draw Key, D.O. = Dual Draw Key on Opposite Sides of Pin, D.I. = Dual Draw Key In-Line on Same Side of Pin.**

SPICER STEER AXLE SERVICE PARTS

King Pin Kits

Model	Kit Part #	Size*	Bushing Type**	Pin Type***	Pin Length	Pin Diameter
EFA24T2/T5 pre 1/1/00	811525	Standard	G	S	9.965	1.873
FA10	62905R93	Standard	B	S	5.44	0.861
FA48 - No Longer Available	134455R91	.015/OS	B	S	6.25	1.123
	69971R91	Standard	B	S	6.25	1.109
FA68, FA72	134456R91	.015/OS	B	S	6.75	1.248
	70594R91	Standard	B	S	6.75	1.234
FA89, FA91, FA98	134457R91	.015/OS	B	S	7.65	1.248
	61556R91	Standard	B	S	7.66	1.234
FA109	493092C92	.002/OS	B	S	8.85	1.486
	591945C92	Standard	B	D.O.	8.85	1.484
FA118,127, 139, 242, 248, 337, 338, 342, I132-S, I108-S	343KK103	Standard	G	D.O.	9.66	1.609
	337KK104					
	343KK105	Standard	B	D.O.	9.66	1.609
I50, I60, I75, I80(S)	101KK110	.002/OS	G	S	7.97	1.361
	101KK111	Standard	G	D.O.	8.07	1.359
	101KK113	Standard	B	S	7.97	1.359
I90(S)	309KK102	Standard	G	D.O.	9.16	1.609
	309KK103	Standard	B	D.O.	9.16	1.609
	337KK103	.002/OS	G	S	9.16	1.611
I100(S), I120(S)	120KK100	Standard	G	D.O.	9.87	1.921
I120SA, I140SA, I146SA	120KK102	Standard	G	D.O.	10.77	1.86
I132S, I140S	140KK100	Standard	G	D.O.	10.12	2.046
I140W, I100W	329022	Standard	G	D.O.	10.12	2/046
I160(S), I180(S), I200(S)	151KK101	Standard	G	D.O.	10.94	2.046
I160SG, I180SG, I200SG, I120SG, I140SG	220KK100	Standard	G	D.O.	10.94	2.046
I160SB	161KK100	Standard	G	D.O.	11.00	2.046
I160W	329023	Standard	G	D.O.	10.94	2.046
I180W, I200W, I220W	329070	Standard	G	D.O.	10.94	2.046

KEY: *OS = Oversize **Bushing Type: B = Bronze, G = Presized Garlock *Pin Type: S = Single Draw Key, D.O. = Dual Draw Key on Opposite Sides of Pin, D.I. = Dual Draw Key In-Line on Same Side of Pin.**

Tie Rod Assemblies/Kits (I Family)

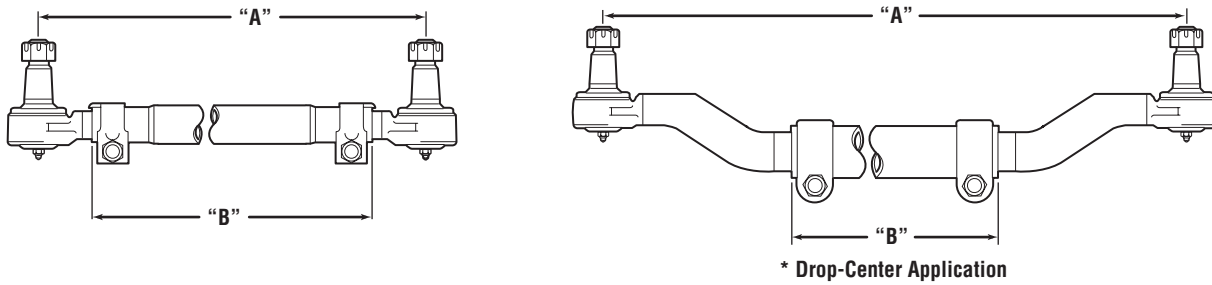

I-80, I-100 Tie Rod Assemblies

TIE ROD END ASSY - COMPLETE			CROSS TUBES			TIE ROD ENDS		
I-80	I-100	Assy. Length "A"	Cross Tube Width	Cross Tube Assy. (includes clamp)	Tube Length "B"	LH Side	Type	RH Side
N/A	120TR100-1X	64.72	1.50	120TR106	59.38	120TR109	S	120TR110
N/A	100TR105-3X	64.72	1.44	N/A	59.38	140TR111	S	140TR112
N/A	N/A	64.72	2.25	140TR116-1	42.92	140TR130	D	140TR131
N/A	N/A	65.28	1.62	140TR118	51.79	140TR111	S	140TR112
N/A	220TR114-1*	65.62	2.50	220TR120	48.20	220TR118	D	220TR119
N/A	120TR100-2X	65.92	1.50	120TR107	60.56	120TR109	S	120TR110
N/A	100TR105-4X	65.92	1.44	100TR109	60.56	140TR111	S	140TR112
N/A	N/A	65.92	1.62	140TR107	60.56	140TR109	S	140TR110
N/A	N/A	65.92	2.25	"N/A"	43.38	140TR130	D	140TR131
N/A	220TR100-3	66.24	1.75	220TR117-3	61.00	220TR115	S	220TR116
N/A	N/A	66.90	1.75	N/A	60.00	817018	S	817019
N/A	100TR111-1X	67.12	1.44	100TR112	67.12	140TR111	S	140TR112
N/A	N/A	67.12	2.00	120TR122-2	43.38	140TR114	D	140TR115
N/A	N/A	67.12	1.62	140TR108	53.63	140TR111	S	140TR112
N/A	N/A	67.96	1.50	120TR134	62.60	140TR109	S	140TR110
080TR109-3	N/A	68.64	1.44	080TR115	50.32	080TR116	D	080TR117
N/A	N/A	68.90	1.66	971444	62.00	817018	S	817019

D = Drop Socket Design S = Straight Design

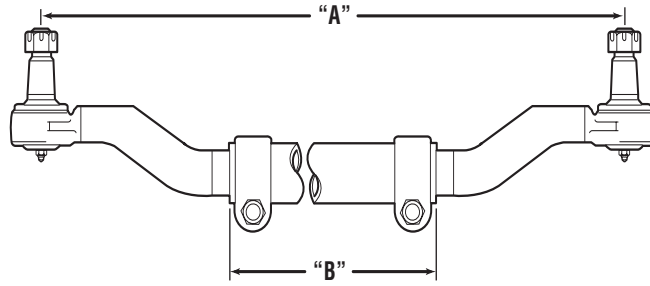
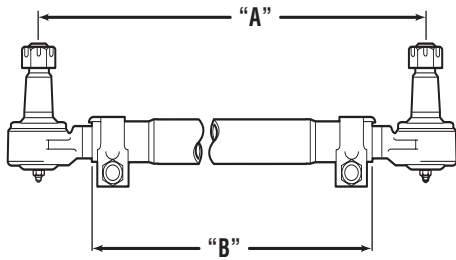

* Drop-Center Application

I-120, I-130, I-132, I-140 Tie Rod Assemblies

TIE ROD END ASSY - COMPLETE			CROSS TUBES			TIE ROD ENDS		
I-120	I-130, I-132, I-140	ASSY LENGTH "A"	CROSS TUBE WIDTH	CROSS TUBE ASSY (includes clamp)	TUBE LENGTH "B"	LH Side	Type	RH Side
N/A	N/A	64.72	1.50	120TR106	59.38	120TR109	S	120TR110
N/A	N/A	64.72	1.44	N/A	59.38	140TR111	S	140TR112
N/A	140TR129-1*	64.72	2.25	140TR116-1	42.92	140TR130	D	140TR131
N/A	140TR105-2	65.28	1.62	140TR118	51.79	140TR111	S	140TR112
220TR114-1*	220TR114-1*	65.62	2.50	220TR120	48.20	220TR118	D	220TR119
N/A	120TR100-2X	65.92	1.50	120TR107	60.56	120TR109	S	120TR110
N/A	N/A	65.92	1.44	100TR109	60.56	140TR111	S	140TR112
N/A	140TR100-2X	65.92	1.62	140TR107	60.56	140TR109	S	140TR110
N/A	140TR129-2*	65.92	2.25	N/A	43.38	140TR130	D	140TR131
220TR100-3	220TR100-3	66.24	1.75	220TR117-3	61.00	220TR115	S	220TR116
N/A	815326	66.90	1.75	N/A	60.00	817018	S	817019
N/A	N/A	67.12	1.44	100TR112	67.12	140TR111	S	140TR112
120TR123-3*	N/A	67.12	2.00	120TR122-2	43.38	140TR114	D	140TR115
N/A	140TR105-1	67.12	1.62	140TR108	53.63	140TR111	S	140TR112
120TR130-2	N/A	67.96	1.50	120TR134	62.60	140TR109	S	140TR110
N/A	N/A	68.64	1.44	080TR115	50.32	080TR116	D	080TR117
N/A	971443	68.90	1.66	971444	62.00	817018	S	817019

D = Drop Socket Design S = Straight Design

I-100W, I-120W, I-140W Tie Rod Assemblies

TIE ROD END ASSEMBLY - COMPLETE				CROSS TUBES			TIE ROD ENDS		
I-100W	I-120W	I-140W	ASSY LENGTH: "A"	CROSS TUBE WIDTH	CROSS TUBE ASSY (includes clamp)	TUBE LENGTH "B"	LH Side	Type	RH Side
971092			68.50	1.90	971093	61.00	818472	S	818471
D = Drop Socket Design S = Straight Design									

Tie Rod Assemblies (D, E & EFA Families)

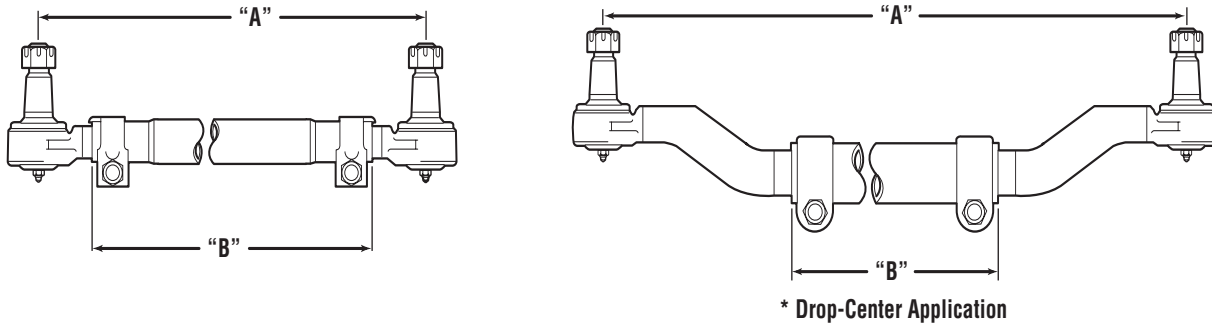

D-600, D-700, D-800, D-850 Tie Rod Assemblies

TIE ROD END ASSY - COMPLETE				CROSS TUBES			TIE ROD ENDS		
D-600, D-700	D-800	D-850	Assy. Length "A"	Cross Tube Width	Cross Tube Assy. (includes clamp)	Tube Length "B"	LH Side	Type	RH Side
971814	N/A	N/A	62.00	1.66	N/A	55.00	817018	S	817019
N/A	971762	971762	67.60	1.75	N/A	56.00	970579	D	970580
N/A	971314	971314	71.10	1.66	N/A	63.50	817018	S	817019
D = Drop Socket Design S = Straight Design									

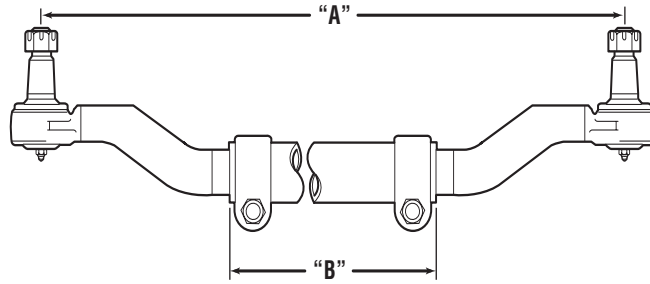
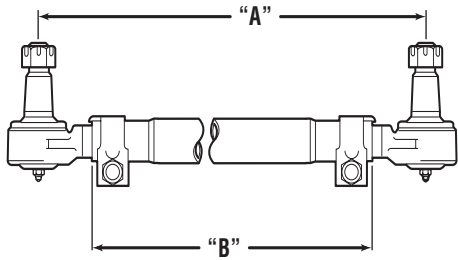

* Drop-Center Application

E-1000I, E-1002I, E-1200I, E-1202I, E-1320I, E-1322I, E-1460I, E-1462I Tie Rod Assemblies

TIE ROD END ASSEMBLY - COMPLETE			CROSS TUBES		TIE ROD ENDS			
E-1000I, E-1002I, E-1200I, E-1202I, E-1320I, E-1322I, E-1460I, E-1462I	ASSY LENGTH "A"	TUBE WIDTH	CROSS TUBE ASSY (includes clamp)	CROSS TUBE LENGTH "B"	LH Side	Type	RH Side	End Length
818462	65.90	1.53	N/A	60.00	817018	S	817019	6.00
970578	65.90	1.75	N/A	53.50	970579	D	970580	9.26
817755	66.50	1.90	818473	59.00	818472	S	818471	7.50
818704	66.50	2.00	N/A	44.25	818706	D	818705	14.28
815326	66.90	1.75	N/A	60.00	817018	S	817019	6.00
971762	67.60	1.75	N/A	56.00	970579	D	970580	9.26
971092	68.50	1.90	971093	61.00	818472	S	818471	7.50
971443	68.90	1.66	971444	62.00	817018	S	817019	6.00
971088	69.75	1.66	971089	62.50	817018	S	817019	6.00

D = Drop Socket Design S = Straight Design

EFA 10F4, 12F4, 13F5 Tie Rod Assemblies

TIE ROD END ASSEMBLY - COMPLETE			CROSS TUBES		TIE ROD ENDS			
EFA10F4, 12F4, 13F5	ASSY LENGTH "A"	TUBE WIDTH "B"	CROSS TUBE ASSY (includes clamp)	CROSS TUBE LENGTH	LH Side	Type	RH Side	End Length
1005692	64.69	1.75	N/A	59.43	140TR109	S	140TR110	5.44
1005693	65.75	1.75	N/A	60.50	140TR109	S	140TR110	5.44
970578	65.90	1.75	N/A	53.50	970579	D	970580	9.26
1008060	66.77	2.00	1006732	60.50	140TR109	S	140TR110	5.44
806962*	67.54	1.75	N/A	62.30	140TR109	S	140TR110	5.44
1009248*	67.54	1.75	1009249	62.30	140TR109	S	140TR110	5.44
811942	67.60	1.80	811941	56.30	1009009	D	1009010	8.12

D = Drop Socket Design S = Straight Design
806962 = 1/2" bolt clamp, 1009248 = 5/8" bolt clamp

EFA18F3, 20F4, 22T2/T5, 24T2/T5 Tie Rod Assemblies

TIE ROD END ASSY - COMPLETE			CROSS TUBES & ENDS		TIE ROD ENDS			
EFA18F3, 20F4, 22T2/T5, 24T2/T5	ASSY LENGTH "A"	TUBE WIDTH	CROSS TUBE ASSY (includes clamp)	CROSS TUBE LENGTH "B"	LH Side	Type	RH Side	End Length
822074	60.00	2.00	820632	52.00	820626	S	820627	7.38
820623	62.00	1.75	820661	54.00	820626	S	820627	7.38
822073	64.00	2.00	N/A	56.00	820626	S	820627	7.38
820625	66.00	1.75	N/A	66.00	820626	S	820627	7.38
822076	68.00	2.00	820634	60.00	820626	S	820627	7.38
822077	72.00	2.00	820635	64.00	820626	S	820627	7.38
821828	76.00	2.00	820636	68.00	820626	S	820627	7.38
822081	80.00	2.00	820637	72.00	815122	S	815123	7.38
822078	84.00	2.00	820638	76.00	820626	S	820627	7.38
821829	88.00	2.00	820639	80.00	815122	S	815123	7.38
820678	94.00	2.00	N/A	88.00	820694	F	820694	5.88

D = Drop Socket Design S = Straight Design F = Female Threaded/Straight Design

Shown below are several part numbers that have been, or should be serviced by the most optimal part Spicer offers thru Service. Use this when receiving part number inquiries from customers.

Cross Tube & Tie Rod End Assemblies Cross Reference

ORIGINAL DANA PART NUMBER	PART DESCRIPTION	FOR SERVICE ORDER SPICER P/N:	NOTES
806963	CROSS TUBE ASSY	806962	
811940	TIE ROD END ASSY	970578	
813975	TIE ROD END ASSY	1005693	
815327	CROSS TUBE ASSY	815326	
816711	TIE ROD END ASSY	815326	
817020	CROSS TUBE ASSY	815326	
818463	CROSS TUBE ASSY	818462	
818707	CROSS TUBE ASSY	818704	
820668	CROSS TUBE ASSY	822350	
820673	CROSS TUBE ASSY	820678	
821067	TIE ROD END ASSY	970578	
970581	CROSS TUBE ASSY	970578	
971090	TIE ROD END ASSY	971088	
971094	TIE ROD END ASSY	971092	
971097	CROSS TUBE ASSY	971096	
971190	TIE ROD END ASSY	817755	
971463	CROSS TUBE ASSY	971762	
971815	CROSS TUBE ASSY	971814	
1006144	CROSS TUBE ASSY	1005692	
1006145	CROSS TUBE ASSY	1005693	
1006148	TIE ROD END	140TR109	
1006149	TIE ROD END	140TR110	
1008846	TIE ROD END ASSY	1005692	
100TR108	CROSS TUBE ASSY	100TR105-3X	
101TR100	TIE ROD END ASSY	None	I-75 Series
140TR116-2	CROSS TUBE ASSY	140TR129-2	

DRIVE AXLE SERVICE PARTS

Bearing Kits

FEATURES:

- Each bearing kit comes complete with exactly the right combination of parts you need to get your axle back in shape and on the road
- Highest quality mix of bearings, cups, and cones for performance you can count on.
- Premium oil seals to keep lube in, and dust and road grime out
- Handy RTV compound to seal the repair

NOTE: Kits are listed by the “base” model designation in numeric sequence.



Bearing Kits

Model	Part #	Model	Part #	Model	Part #
15040S	512803	19227 - built before 2/1/79	99349	23320 w/case part # 103537	107670
15200, 15300	99048	19300	99052	23320 w/case part # 28950	99053
16120	99040	19320	99053	23327 built after 2/1/79	103512
16124	119603	19327	99349	23327 built before 2/1/79	99349
16220	99049	20100	99042	23420 built after 2/1/79	103512
16244	99050	20120	99043	23420 built before 2/1/79	99349
16320	99049	20200	99052	23427	103512
16344	99050	20220	99053	26121	99043
17100, 17120	99041	20300	99052	26121 w/CTD	99096
17200, 17220, 17300, 17320	99051	20320	99053	35227 built after 2/1/79	103512
18100, 18120	99041	22121	109368	35227 built before 2/1/79	99349
18200, 18220, 18300, 18320	99051	22221, 22321	109369	35327 built after 2/1/79	103512
19050S	512804	23105S, 26105S, 30105S	119797	35327 built before 2/1/79	99349
19100	99042	23120	99096	34 DP/DT	99054
19120	99043	23220 w/case part # 103537	107670	34 DS	99044
19200	99052	23220 w/case part # 28950	99053	34 RP/RT/R3	99051
19220	99053	23227 built after 2/1/79	103512	34 RS	99041
19227, 19237 built after 2/1/79	103512	23227 built before 2/1/79	99349	38 DP/DT	99054

DRIVE AXLE SERVICE PARTS

Bearing Kits

Model	Part #	Model	Part #	Model	Part #
38 DS	99044	110S, 130S	511859	380 RP/RT	99051
38 RP/RT/R3	99051	170D	514011	380 RS built after 5/1/78	99041
38 RS	99041	170R - Ratios 2.69-3.91	514013	380 RS built before 5/1/78	99051
40 DSH	512812	170R - Ratios 4.10-7.17	514014	381(P) DP/DT	115125
40 RSH	512806	170S - Ratios 2.69-3.91	514013	381(P) DS	114394
40 RST - Ratios 2.64-5.57 Built after 4/1/05	514059	170S - Ratios 4.10-7.17	514014	381 RP/RT	99051
40 RST - Ratios 2.64-5.57 Built before 4/1/05	512828	190D	514012	381 RS	99041
40 RST - Ratios 6.17-7.17 Built after 4/1/05	514060	190R - Ratios 2.53-4.78	514015	400(P) DP/DT	99045
40 RST - Ratios 6.17-7.17 Built before 4/1/05	512829	190R - Ratios 5.25-7.83	514016	400(P) DS	106845
41 RST - Ratios 2.64-5.57 Built after 4/1/05	514059	190S - Ratios 2.53-4.78	514015	400 RP/RT	99051
41 RST - Ratios 2.64-5.57 Built before 4/1/05	512828	190S - Ratios 5.25-7.83	514016	400 RS built after 5/1/78	99041
41 RST - Ratios 6.17-7.17 Built after 4/1/05	514060	340 DP/DT	99045	400 RS built before 5/1/78	99051
41 RST - Ratios 6.17-7.17 Built before 4/1/05	512829	340 DS	106845	401(P) DP/DT	115125
42 DP/DT	99054	340 RP/RT	99051	401(P) DS	114394
42 RP/RT	99051	340 RS built after 5/1/78	99041	401 RP/RT	99051
44 DP/DT	99348	340 RS built before 5/1/78	99051	401 RS	99041
44 DS	103511	341 DP/DT	115125	402(P) DA/DS built after 1/1/95	114394
44 RP/RT	99053	341 DS built after 1/1/95	114394	402(P) DA/DS built before 1/1/95	211222
44 RS built after 2/1/79	103512	341 DS built after 4/6/89	211222	402(P) DP/DT	115125
44 RS built before 2/1/79	99349	341 RP/RT	99051	402(P) DS built before 4/6/89	114394
44 RS w/case # C67854	99043	341 RS built after 1/1/95	509689	402 RA/RS built after 1/1/95	509689
44 RS w/case # C98493	99096	341 RS built after 4/6/89	211223	402 RA/RS built before 1/1/95	211223
44 DSH	512812	344 DA/DS	216234	402 RP/RT	99051
44 RSH	512806	344 RA/RS	216248	402 RS built before 4/6/89	99041
50 DP/DT	99045	380 DP/DT	99045	403(P) DS built after 1/1/95	114394
50 RP/RT	99051	380 DS	106845	403(P) DS built after 4/6/89	211222

DRIVE AXLE SERVICE PARTS

Bearing Kits

Model	Part #	Model	Part #	Model	Part #
403(P) DS built before 4/6/89	114394	460(P) DS	118122	G155T, G175T	GGAKA101 X
403 RS built after 1/1/95	509689	460(P) DS w/CTD sub. seal	118315	IHC 'RA'	429KS100
403 RS built after 4/6/89	211223	460 RP/RT	107670	J175S, J190S	472KS101
403 RS built before 4/6/89	99041	460 RS	99096	J210S, J220S	472KS101
404 DD	512800	461P DS	512802	J230S	472KS101
404(P) DA/DS	216234	461 RS	512814	J340S, J380S, J400 S (FR)	472KS113
404 RA/RS	216248	480(P) DP/DT - 22 spline	107669	J340S, J380S, J400S (RR)	472KS101
404 RD	512805	480(P) DP/DT - 36 spline	118118	J400S (FR)	472KS113
405(P) DA/DS	216234	480(P) DS - 22 spline	99046	J400S (FR) Complete	472KS113
405 RA/RS	216248	480(P) DS - 36 spline	118122	M190T, M210T, M220T, M230T	MJAKA101 X
440(P) DP/DT - 22 spline	107669	480(P) DS - w/CTD	103511	N340, N400 (FR) International Exclusive	401KS100 X
440(P) DP/DT - 36 spline	118118	480(P) DS - w/CTD sub. seal	118315	N340, N400 (RR) International Exclusive	401KS101 X
440(P) DS - 22 spline	99046	480 RP/RT	107670	S135S, S150S	360KS100 X
440(P) DS - 36 spline	118122	480 RS	99096	S230S, S260S	300KS100 X
440 RP/RT	107670	480 RS w/CTD	103512	S400S (FR)	390KS105 X
440 RS	99096	580(P) DP/DT	103511	S400S (RR)	390KS103 X
451(P) DP/DT	115125	580(P) DS - w/CTD	103511	W230S, W440S, W460S (RR)	474KS101
451(P) DS built after 1/1/95	114394	580(P) DS - w/CTD sub. seal	118315	W440S, W460S (FR)	474KS102
451(P) DS built after 4/6/89	211222	580 RP/RT	103512		
451(P) DS built before 4/6/89	114394	580 RS w/CTD	103512		
451 RP/RT	99051	650(P) DP/DT	103511		
451 RS built after 1/1/95	509689	650(P) DS - w/CTD	103511		
451 RS built after 4/6/89	211223	650(P) DS - w/CTD sub. seal	118315		
451 RS built before 4/6/89	99041	650 RP/RT	103512		
454(P) DA/DS	216234	650 RS w/CTD	103512		
454 RA/RS	216248	F155S	341KS101		
460(P) DP/DT - 22 spline	107669	F170S	341KS101		
460(P) DP/DT - 36 spline	118118	F300S	341KS100		

Basic Overhaul Kits

FEATURES:

- Our most comprehensive kit comes complete with everything you need for a thorough and lasting repair.
- Highest quality mix of bearings, cups, and cones, each precisely selected for maximum performance in every position and application
- Premium oil seals for your best protection against nagging leaks and damaging contamination
- Production upgrades that keep Genuine Spicer parts better than the OE parts they replace.



Basic Overhaul Kits

Model	Overhaul Kit Part Number	Model	Overhaul Kit Part Number
110S, 130S	511859	21065 D/S	121769
13802	110565	21065 P/T	110635
15040 P/T	121799	22065S	121769
15040S	121733	22120	110634
15100	120580	22220, 22320	110635
15200, 15300	110565	22420, 22427	118688
16120, 16123	110553	23105C	121340
16124, 16144	119606	23105D	123297
16220, 16320	110602	23105S	119801
16244, 16344	110567	23120 - Large Spherical Diff	110559
17-18 Series Single Speed Carriers	110555	23220, 23320 - w/case #27950	110572
17200, 17220, 17300, 17320	110585	23220, 23320 - w/case #103537	110598
18200, 18220, 18300, 18320	110585	23227, 23327	110604
19050 D/S	121747	23430, 23433 w/CTD	122448
19050 P/T	121806	26085 P/T - Built after 4/6/88	122424
19055 D/S	121769	26085 P/T - Built before 4/6/88	121828
19055 P/T	110635	26120 - Large Spherical Diff	110559
19060D, 21060D	217464	26220, 26223, 26320, 26323	110572
19060S, 21060S	216221	34 RP/RT	110585
19060T, 21060T	110585	34 RS - Single Speed	110555
19220, 19223, 19320, 19323	110572	38 RP/RT	110585
20220, 20223, 20320, 20323	110572	38 RS	110555

SPICER DRIVE AXLE SERVICE PARTS

Basic Overhaul Kits

Model	Overhaul Kit Part Number	Model	Overhaul Kit Part Number
340 DP/DT	110584	40 RDH	510400
340 DS - Built after 4/30/78	110593	40 RDS	217622
340 RP/RT	110585	40 RSH	510398
340 RS - Built after 4/30/78	110555	40 RSS	122434
340 RS - Built before 4/30/78	110579	40 RST - Ratios 2.64-5.57, Built after 4/1/05	514061
341 DS - Built after 1/1/95	509691	40 RST - Ratios 2.64-5.57, Built before 4/1/05	511115
341 DS - Built after 4/6/89	124487	40 RST - Ratios 6.17-7.17, Built after 4/1/05	514062
341 DS - Built before 4/6/89	114399	40 RST - Ratios 6.17-7.17, Built before 4/1/05	512830
341(P) DC	213422	41(P) DDT	217463
341(P) DP/DT	115124	41(P) DST	216220
341 RC/RP/RT	110585	41 RST - Ratios 2.64-5.57, Built after 4/1/05	514061
341 RS - Built after 1/1/95	509690	41 RST - Ratios 2.64-5.57, Built before 4/1/05	511115
341 RS - Built after 4/6/89	211218	41 RST - Ratios 6.17-7.17, Built after 4/1/05	514062
341 RS - Built before 4/6/89	110555	41 RST - Ratios 6.17-7.17, Built before 4/1/05	512830
344 DS	216220	42 RP/RT	110585
344 RS	216221	44(P) DDH	510399
380 DP/DT	110584	44(P) DSH	510393
380(P) DS - Built after 4/30/78	110593	44 RDH	510400
380 RP/RT	110585	44 RP/RT	110572
380 RS - Built after 4/30/78	110555	44 RS - w/case part # C98493	110559
380 RS - Built before 4/30/78	110579	44 RSH	510398
381(P) DC	213422	400 DP/DT	110584
381(P) DP/DT	115124	400P DS - Built after 4/30/78	110593
381(P) DS	114399	400 RP/RT	110585
381 RP/RT	110585	400 RS - Built after 4/30/78	110555
381 RS	110555	400 RS - Built before 4/30/78	110579
35227, 35327	110604	401P DC	213422
40(P) DDH	510399	401P DP/DT	115124
40(P) DDS	217621	401P DS	114399
40 DDT	217463	401 RC/RP/RT	110585
40(P) DSH	510393	401 RS	110555
40(P) DSS	509302	402(P) DA - Built after 1/1/95	509691
40(P) DST	216220	402(P) DA - Built after 4/6/89	124487

SPICER DRIVE AXLE SERVICE PARTS

Basic Overhaul Kits

Model	Overhaul Kit Part Number	Model	Overhaul Kit Part Number
402(P) DC	213422	451P DS - Built after 1/1/95	509691
402(P) DP/DT	115124	451P DS - Built after 4/6/89	124487
402(P) DS - Built after 1/1/95	509691	451P DS - Built before 4/6/89	114399
402(P) DS - Built after 4/6/89	124487	451 RP/RT	110585
402(P) DS - Built before 4/6/89	114399	451 RS - Built after 1/1/95	509690
402 RA - Built after 1/1/95	509690	451 RS - Built after 4/6/89	211218
402 RA - Built after 4/6/89	211218	451 RS - Built before 4/6/89	110555
402 RC/RP/RT	110585	454(P) DA/DS	216220
402 RS - Built after 1/1/95	509690	454(P) DD	217463
402 RS - Built after 4/6/89	211218	454 RA/RS	216221
402 RS - Built before 4/6/89	110555	454 RD	217464
403P DS - Built after 1/1/95	509691	460P DP/DT - 22 spline	110597
403P DS - Built after 4/6/89	124487	460P DP/DT - 36 spline	118117
403P DS - Built before 4/6/89	114399	460P DS - 22 spline	110595
403 RS - Built after 1/1/95	509690	460P DS - 36 spline	118109
403 RS - Built after 4/6/89	211218	460 RP/RT	110598
403 RS - Built before 4/6/89	110555	460 RS	110596
404P DA/DS	216220	461P DC	122657
404P DD	217463	461(P) DD	217621
404 RA/RS	216221	461P DP/DT	122421
404 RD	217464	461P DS	122437
405P DA/DS	216220	461 RC	122448
405P DD	217463	461 RD	217622
405 RA/RS	216221	461 RP/RT	122424
405 RD	217464	461 RS	122434
440P DP/DT - 22 spline	110597	480P DP/DT - 22 spline	110597
440P DP/DT - 36 spline	118117	480P DP/DT - 36 spline	118117
440P DS - 22 spline	110595	480P DS - 22 spline	110599
440P DS - 36 spline	118109	480P DS - 36 spline	118121
440 RP/RT	110598	480 RP/RT	110598
440 RS	110596	480 RS	120738
451P DC	213422	480 RS - Large Spherical Diff	110559
451P DP/DT	115124	485 RP/RT	110604

Basic Overhaul Kits

Model	Overhaul Kit Part Number	Model	Overhaul Kit Part Number
50 DP/DT	110584	601P DD	217621
50 RP/RT	110585	601P DP/DT	122421
521P DC	122657	601P DS	122437
521P DD	217621	601 RC	122448
521P DP/DT	122421	601 RD	217622
521P DS	122437	601 RP/RT	122424
521 RC	122448	601 RS	122434
521 RD	217622	650P DP - w/case #103530	110605
521 RP/RT	122424	650 RP	110604
521 RS	122434	651P DD	217621
580P DP - w/ case # 103530	110605	651P DP/DT	122421
580 RP/RT	110604	651P DS	122437
581P DD	217621	651 RC	122448
581P DS	122437	651 RD	217622
581 RD	217622	651 RP/RT	122424
581 RS	122434	651 RS	122434

Ring Gear & Pinion Sets

FEATURES:

- All ring gear and pinion sets designed and tested to meet original equipment specifications
- Built to the latest designs that include premium heat treat processes and the most optimum tooth profiles for applications like off-road high horsepower trucks or noise sensitive bus and motor home applications
- High grade steel used to achieve maximum durability
- Priced competitively against non-genuine gearing and backed 100% by Spicer's Field Marketing

NOTE: Each service kit includes a new pinion nut. As a reference, the appropriate Ring Gear Nut and Bolt Kit part number is listed in each model section where applicable. Many Dana Legacy models used rivets before 1993. You can replace rivets with ring gear bolts.

Axle Model	Ring & Pinion Kit Part #	Ratio	Ring Gear Bolt Kits	Notes
15040S	122347	3.36	121736	
	122348	3.55	121736	
	122349	3.70	121736	
	122350	3.90	121736	
	122231	4.11	121736	
	122232	4.33	121736	
	122351	4.63	121736	
	121738	4.88	121736	
	121739	5.29	121736	
	217472	5.38	121736	
	122331	5.57	121736	
	121740	5.83	121736	
	121741	6.17	121736	
	122019	6.50	121736	
	121742	7.17	121736	
15040T	122011	4.56 / 6.34	121448	
	211426	4.56 / 6.34	121448	Right Hand Spiral Gear
	121801	5.14 / 7.16	121448	
	121802	5.57 / 7.75	121448	
	121803	5.86 / 8.15	121448	
	121804	6.29 / 8.75	121448	
16220	098743	6.50 / 9.04	121449	
16244	096798	4.88 / 6.55	121449	
	118928	5.29 / 7.21	121449	
	096799	5.57 / 7.60	121449	
17100/18100	096622	4.56	87955	16" gearing; 5/8" bolt hole

SPICER DRIVE AXLE SERVICE KITS

Axle Model	Ring & Pinion Kit Part #	Ratio	Ring Gear Bolt Kits	Notes
17100/18100 (continued)	096623	4.88	87955	16" gearing; 5/8" bolt hole
	096624	5.29	87955	16" gearing; 5/8" bolt hole
	096625	5.57	87955	16" gearing; 5/8" bolt hole
17200	096833	3.70 / 5.05	70745	16" gearing; 5/8" bolt hole
	096837	4.88 / 6.65	70745	16" gearing; 5/8" bolt hole
	096838	5.29 / 7.21	70745	16" gearing; 5/8" bolt hole
	096839	5.57 / 7.60	70745	16" gearing; 5/8" bolt hole
	096841	6.14 / 8.38	70745	16.5" gearing; 5/8" bolt hole
	113467	6.57 / 8.96	70745	16.5" gearing; 5/8" bolt hole
	096843	7.17 / 9.97	70745	16.5" gearing; 5/8" bolt hole
19050T/P	121546	4.88 / 6.78	121449	
	121547	5.29 / 7.33	121449	
	121548	5.57 / 7.75	121449	
	121549	6.14 / 8.54	121449	
	121550	6.57 / 9.14	121449	
	121551	7.17 / 9.97	121449	
21065S/D	122352	3.08	121772	
	122354	3.36	121772	
	121775	3.90	121772	
	122209	4.11	121772	
	122109	4.33	121772	
	122099	4.63	121772	
	121776	4.88	121772	
	121777	5.29	121772	
	121778	5.57	121772	
	122018	5.83	121772	
	121779	6.17	121772	
	121780	6.50	121772	
	121781	7.17	121772	
21065T/P	121815	6.50 / 8.86	87955	
34DSB	095539	4.56	70745	16" gearing; 5/8" bolt hole
	095540	4.88	70745	16" gearing; 5/8" bolt hole
	095541	5.29	70745	16" gearing; 5/8" bolt hole

SPICER DRIVE AXLE SERVICE PARTS

Axle Model	Ring & Pinion Kit Part #	Ratio	Ring Gear Bolt Kits	Notes
34DTB	095547	3.70 / 5.05	87955	16" gearing; 5/8" bolt hole
D135	69021R93	5.29	Not Applicable	10 STR Spline
	578793C91	5.38	Not Applicable	10 STR Spline
	69022R93	6.17	Not Applicable	10 STR Spline
	69015R93	7.17	Not Applicable	10 STR Spline
DS340, DS380	095557	3.70	70745	16" gearing; 5/8" bolt hole
	095559	4.33	70745	16.5" gearing; 5/8 bolt holes
	095560	4.56	70745	16.5" gearing; 5/8 bolt holes
DT340, DT380	095567	4.11 / 5.61	87955	16.5" gearing; 5/8 bolt holes
	095568	4.33 / 5.91	87955	16.5" gearing; 5/8 bolt holes
	095569	4.56 / 6.21	87955	16.5" gearing; 5/8 bolt holes
F155, F170	586152C91	4.78	390KY101-X	10 STR Spline
	68906R94	5.57	390KY101-X	10 STR Spline
	68907R94	6.50	390KY101-X	10 STR Spline
	68908R94	7.17	390KY101-X	10 STR Spline
	039KG100 X	4.33	390KY101-X	34 Involute
	029KG107 X	4.56	390KY101-X	34 Involute
	029KG100 X	4.78	390KY101-X	34 Involute
	029KG101 X	5.57	390KY101-X	34 Involute
	029KG102 X	6.50	390KY101-X	34 Involute
	029KG103 X	7.17	390KY101-X	34 Involute
G155T, G175T	GGAKG127 X	4.56 / 6.34	Not Applicable	
	GGAKG117 X	4.89 / 6.80	Not Applicable	
	GGAKG126 X	4.89 / 6.80	Not Applicable	Includes bearings & bolts
	GGAKG104 X	4.89 / 6.80	Not Applicable	Complete with bearings, bolts, & seals
	GGAKG118 X	5.57 / 7.75	Not Applicable	
	GGAKG122 X	5.57 / 7.75	Not Applicable	Includes bearings & bolts
	GGAKG119 X	6.17 / 8.58	Not Applicable	
	GGAKG123 X	6.17 / 8.58	Not Applicable	Includes bearings & bolts
	GGAKG120 X	6.50 / 9.04	Not Applicable	
	GGAKG124 X	6.50 / 9.04	Not Applicable	Includes bearings & bolts
	GGAKG121 X	7.17 / 9.97	Not Applicable	
	GGAKG125 X	7.17 / 9.17	Not Applicable	Includes bearings & bolts

SPICER DRIVE AXLE SERVICE KITS

Axle Model	Ring & Pinion Kit Part #	Ratio	Ring Gear Bolt Kits	Notes
J-Series 175, 190, 210, 220, 340, 380, 400	597236C91	3.54	390KY101-X	16" Hypoid Gearing
	597237C91	3.73	390KY101-X	
	597238C91	3.91	390KY101-X	
	597239C91	4.10	390KY101-X	
	597240C91	4.44	390KY101-X	
	597241C91	4.78	390KY101-X	
	047KG100 X	5.11	390KY101-X	
	597242C91	5.38	390KY101-X	
	047KG101 X	5.63	390KY101-X	
	597243C91	6.14	390KY101-X	
	597244C91	6.57	390KY101-X	
	597245C91	7.17	390KY101-X	
	597246C91	8.17	390KY101-X	
M190T, M210T, M220T, M230T	MJAKG137 X	3.70 / 5.05	N/A	
	MJAKG146 X	3.90 / 5.32	N/A	
	MJAKG132 X	4.11 / 5.60	N/A	
	MJAKG133 X	4.56 / 6.22	N/A	
	MJAKG112 X	4.56 / 6.22	N/A	Special kit complete w/bearings & seals
	MJAKG119 X	4.89 / 6.66	N/A	
	MJAKG109 X	4.89 / 6.66	N/A	Special kit complete w/bearings & seals
	MJAKG134 X	5.29 / 7.21	N/A	
	MJAKG120 X	5.57 / 7.60	N/A	
	MJAKG121 X	6.14 / 8.38	N/A	
	MJAKG122 X	6.50 / 8.87	N/A	
	MJAKG123 X	7.17 / 9.77	N/A	
RS340, RS380	096642	4.11	70745	16.5" gearing; 5/8" bolt holes
	096643	4.33	70745	16.5" gearing; 5/8" bolt holes
	096644	4.56	70745	16.5" gearing; 5/8" bolt holes
RT340, RT380	098117	4.56 / 6.21	87955	16.5" gearing; 5/8" bolt holes
S230, S260	300KG100 X	3.07	300KY100 X	
	300KG107 X	3.54	300KY100 X	
	300KG103 X	3.73	300KY100 X	

SPICER DRIVE AXLE SERVICE PARTS

Axle Model	Ring & Pinion Kit Part #	Ratio	Ring Gear Bolt Kits	Notes
S230, S260 (continued)	300KG108 X	3.91	300KY100 X	
	300KG109 X	4.10	300KY100 X	
	300KG105 X	4.44	300KY100 X	
	300KG106 X	4.78	300KY100 X	
S400 Front Rear	390KG100 X	2.81	390KY100 X	
	390KG101 X	2.93	390KY100 X	
	390KG102 X	3.07	390KY100 X	
	390KG203 X	3.21	390KY100 X	
	390KG204 X	3.42	390KY100 X	
	390KG120 X	3.54	390KY100 X	
	390KG105 X	3.73	390KY100 X	
	390KG106 X	3.91	390KY100 X	
	390KG107 X	4.10	390KY100 X	
	390KG108 X	4.44	390KY100 X	
S400 Rear Rear	390KG110 X	2.81	390KY100 X	
	390KG111 X	2.93	390KY100 X	
	390KG112 X	3.07	390KY100 X	
	390KG213 X	3.21	390KY100 X	
	390KG214 X	3.42	390KY100 X	
	390KG121 X	3.54	390KY100 X	
	390KG115 X	3.73	390KY100 X	
	390KG116 X	3.91	390KY100 X	
	390KG117 X	4.10	390KY100 X	
	390KG118 X	4.44	390KY100 X	
W230, W300	057KG100 X	5.63	057KY101 X	
W440, W460	597247C91	3.54	057KY101 X	
	597248C91	3.73	057KY101 X	
	597249C91	3.91	057KY101 X	
	597250C91	4.10	057KY101 X	
	597251C91	4.44	057KY101 X	
	597252C91	4.78	057KY101 X	
	597253C91	5.38	057KY101 X	
	597254C91	6.14	057KY101 X	

SPICER DRIVE AXLE SERVICE KITS

Axle Model	Ring & Pinion Kit Part #	Ratio	Ring Gear Bolt Kits	Notes
W440, W460 (continued)	597255C91	6.57	057KY101 X	
	597256C91	7.17	057KY101 X	

Seals - Drive, Steer & Wheel Ends

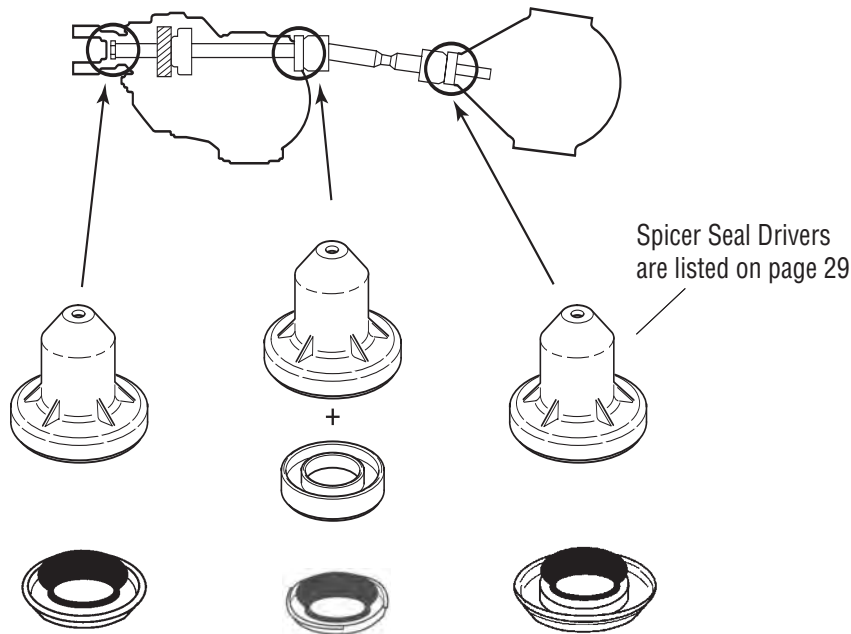

FEATURES:

- Same OEM engineered quality seals used in today's production units which includes the Micro-Lip XL designs
- Seals made of high-performance Viton which prolongs seal life at extreme heat temperatures unlike conventional seals
- Seals are resistant to degradation by a wide spectrum of fluids, including lubricants and their additives

Seals - Rear Pinion Location

Spicer Model	Spicer Part #	Notes
D135, R30	454755C1	Original design
F155S, F170S	454706C1	Original design
	GGAHH106	Part used until July 1991
	029HH100	Used After July 1991. Triple Lip design (brown) *note1
S135, S150	029HH100	Triple Lip design (brown) *note 1
G175S/T, G190S, M190T, M210T, M220T, M230T	070HH139	Original design part used until July 1991
	GGAHH109	Used After July 1991. Triple Lip design (brown) *note1
N175, N190, N210, J175S, J190S, J210S, J220S, J230SB, W230S, G340S (RR), G380S(RR)	GGAHH103	Original design part used until July 1991

Note 1: After March 1993, as a running change, the seal design was changed to Triple Lip design with vents (brown seal lips)

Note 2: Some seals are designed for specific models and may not be backwards compatible to older generation models or models in unique applications like front drive steers. It's best to know seal dimensions if not sure

Seals - Rear Pinion Location

Spicer Model	Spicer Part #	Notes
N175, N190, N210, J175S, J190S, J210S, J220S, J230SB, W230S, G340S (RR), G380S (RR), S400 (RR)	401HH102	Used from July 1991 to Jan 1999. Triple Lip design (brown) *note1
	HH105	New Unitized Seal introduced in Jan, 1999. Replaces both 401HH102 and GGAHH103 for these models only.
15100, 15200	935830	Replaced old#119458
16120, 16244, 15040S, 19055S/D, 21065S/D, 19050S, 19050T/P, 19055T/P, 21065T/P	119427	Triple Lip Viton Design - Used until 1990, replaced by Triple Lip Design #127721 in Tandem Models Only!
17/19/21/22060S/D, R344, 404, 405, 454	127591	Microlip XL Design
19120, 19220, 23220, 23420, 44RS, R440, 460, 480, 580, 650	119432	Triple Lip Viton Design
23070, 23080S/D, 23085S/D, 23090S/D, 23105S/D, R461, 462, 463, 521, 581	210724	Microlip XL Design
23130, RC461	113866	Still used in special applications like "rolled over" and "RH Spiral" carriers. Replaced by the 210724 in Tandem Models. *note 2
G175S/T, G190S, M190T, M210T, M220T, M230T	MJAHH102	Seal goes inside the differential carrier in these models
R341, 381, 402, 451	127721	Microlip XL Design - Replaced the 119427 Triple Lip seal in these models and this location in 1990

Seals - Forward Input Location

Spicer Model	Spicer Part Number	Notes
J380, J400S, W460S	GGAHH102 - NLA	Original design part used until July 1991
	472HH100	Used After July 1991. Triple Lip design (brown) *note1
G340S, G380S	420984C91	Original design
N340S, N400i, S400S	GGAHH104	Original design part used until July 1991
	401HH104	Used After July 1991. Triple Lip design (brown) *note1
44DS/DT, D460, 480, 485, 550,580,650	119430	Triple Lip Viton design
D461, 462, 463, 521, 581, 601, 651, 652	210736	Microlip XL design - replaced the 119430 triple lip seal in these models and this location
D340, 380, 400, D341, 381, 401, 402, 403	119429	Triple Lip Viton design - used until 1990, replaced by triple lip design #127719 in tandem models only!
	127719	Microlip XL design - Replaced the 119429 Triple Lip seal in these models and this location in 1990

Note 1: After March 1993, as a running change, the seal design was changed to Triple Lip design with vents (brown seal lips)

Note 2: Some seals are designed for specific models and may not be backwards compatible to older generation models or models in unique applications like front drive steers. It's best to know seal dimensions if not sure.

Seals - Forward Output Location

Spicer Model	Spicer Part Number	Notes
D344, 404, 405, 454, DSH40, 44, DST40, 41	127592	Microlip XL design
44DS, DS340, 380, 400, DS341, 381, 401, 402, 403, DT341, 381, 402	119431	Triple Lip Viton design - used until 1990, replaced by triple lip design #127720 in tandem models only!
	127720	Microlip XL design - replaced the 119431 triple lip seal in these models and this location in 1990
N340S, N400i, S400S	401HH103	Used after July 1991. Triple Lip design (brown) *note1
J400S, W460S, S400S	GGAAH104	Original design part before July 1991
	472HH101	Used After July 1991. Triple Lip design (brown) *note1
D461, 462, 463, 521, 581, 601, 651, 652	210737	Microlip XL design - replaced the 119429 triple lip seal in these models and this location
<p>Note 1: After March 1993, as a running change, the seal design was changed to Triple Lip design with vents (brown seal lips)</p> <p>Note 2: Some seals are designed for specific models and may not be backwards compatible to older generation models or models in unique applications like front drive steers. It's best to know seal dimensions if not sure.</p>		

Seals - Steer Axles - Knuckle Seal Location

Spicer Model	Spicer Part Number	Notes
I-120	120HH100	Nominal I.D. 1.92"
I-120SA, I-140	140HH100	Nominal I.D. 1.86"
I-160	160HH100	Nominal I.D. 2.05"
EFA-12F4, EFA-13F5	1004783	Nominal I.D. 1.66"
I-132	580325C1	Nominal I.D. 1.65"
I-90	418397C91	Nominal I.D. 1.61"

Seals - Wheel Ends - Hub Seal Location

Spicer Model	Spicer Part Number	Notes
Misc Steer Axles	810196	Seal I.D.: 5.906
Misc Steer Axles	822072	Seal I.D.: 5.906

Dana Oil Seal Installation Tools

Listed below are oil seal driver kits for some popular Dana Tandem Drive Axle models. These kits are available from your local parts dealer.

Models: All D/R341, 402, 403, 451

Order Service Kit: 212139

D-Input: Use in insert part number 127787 with driver part number 126917

D-Output: Use driver part number 127786 only

R-Pinion: Use driver part number 126917 only

Models: All D/R 344, 404, 405, 454, DSP40, DST40, DSH40, DSH44

Order Service Kit: 217414

D-Input: Use driver part number 126917 only

D-Output: Use insert part number 128706 with driver part number 126917

R-Pinion: Use driver part number 126917 only

Models: All D/R461, 462, 463, 521, 581, 651, 652







Order Service Kit: 217590

D-Input: Use inser part number 210750 with driver part number 210749

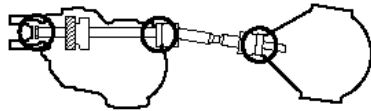
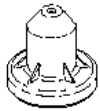
D-Output: Use driver part number 210751 only

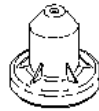
R-Pinion: Use driver part number 210749 only

Pictured below are the seal locations and typical seal installation tools. The Dana 404 Tandem Drive Axle tools are shown in this picture:

	D-Input	D-Output	R-Pinion
Location			
Tool			
Seal			

Wheel Differential Case Kits

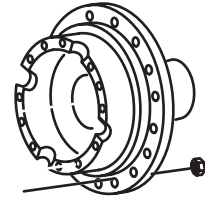
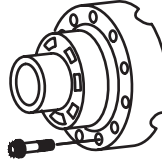
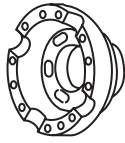
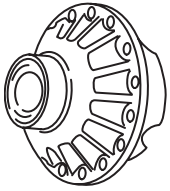

FEATURES:

- All Spicer Differential Case Kits are made with genuine original production parts
- Differential Cases made from high strength, heat-treated iron
- All kits include specific capscrews designed with a thread adhesive that helps maintain the necessary retention in the wheel differential section

Differential Case Kits

Model	Part Number	Ratio	Notes
D135S	493202C91	5.29/7.17	
F155, F170S	592224C91	4.44/5.38	
	493203C91	5.57/7.17	
G155T, G175T	GGAKF102X	All ratios	
J175S, J190S, J210S, J220S, G340, G380, J340S, J380S, J400	586702C91	3.54	
	493204C91	3.43/4.44	
	493205C91	4.78/8.17	
M185T, M190T, M220T, M210T, *M230T	MJAKF100X	All ratios	*This 4 leg-diff case kit has 8 bolt holes, some export M230T axle built w/ special 12 bolt diff cases.
M185T, M190T, M220T, M210T, *M230T	MJAKJ100X	All ratios	*This support case parts kit has a case cap w/ 8 bolt holes. Export M230T axle built w/ special 12 bolt diff cases & case cap.
W230, W460S	586703C91	3.54	
	493206C91	3.43/4.44	
	493207C91	4.78/7.16	
S400 Series	390KQ100X	2.81 & 2.92	
	390KQ101X	3.07 ratio	
	390KQ102X	3.21/3.73	
	390KQ103X	3.91/4.44	
S230S/SI, S230SB, S260SB	300KQ105X	3.07/3.54	Standard diff models
	300KQ106X	3.73/4.44	Standard diff models
	300KQ107X	4.78/5.63	Standard diff models
	300KQ100X	3.07/3.54	For diff-lock models only

Differential Case Kits

Model	Part Number	Ratio	Notes
S230S/SI, S230SB, S260SB (cont.)	300KQ101X	3.73/4.44	For diff-lock models only
	300KQ102X	4.78/5.63	For diff-lock models only
16120, 16130	211570	All ratios	
16220, 16320, 16244*, 16344*, 16247, 16802, 19050T/P, 30DT/RT, 30DP/RP	51559	All ratios	*Diff cases for original build axles. Refer to Note below for conversion part numbers.*
13802, 15200, 15300, 15040T/P	52112	All ratios	
19055S, 21065S, 22065S	211407	3.08/3.55	Standard diff models
	121770	3.70/4.33	Standard diff models
	121771	4.63/7.17	Standard diff models
	122117	3.08/3.55	For diff-lock models only
	122118	3.70/4.33	For diff-lock models only
	122119	4.63/7.17	For diff-lock models only

Note: If the diff. case needs replacement, the entire wheel diff assembly can be upgraded. Upgrade kits vary by side gear. See chart below.

Upgrade Kit No.	Side Gear	Vehicle Mfg.	All kits contain the side gear specified plus the part numbers listed below.
121962	126000 (36 Involute)	Ford, International, GMC	126001 side pinion, 126002 spider, 126003 side pinion thrust washer, 126004 side gear & support case thrust washer, 126006 diff. case with clutchplate pin, 126007 diff. case, 126008 idler pinion pin, 126009 gear support case, 126075 cap screw, and 109238 cap screw.
121963	210386 (30 Involute)	Mack Midliner	
121964	210387 (16 Angular)	Ford (before 2-1-86)	
121965	210388 (16 Straight)	International, GMC (before 2-1-86)	

Wheel Differential Side Gear Kits

FEATURES:

- Precision forged side gears and pinion mates
- Latest designs include premium heat treat processes and the most optimum tooth profiles and tooth angles. High strength steel material used to achieve maximum durability for all types of rugged on & off highway applications
- Wheel Diff Side Gear Kits include: Diff Spider, Side Gears, Side Pinions, Side Gear & Side Pinion Thrust washers

Wheel Differential Side Gear Kits

Spicer Model	Spicer Part Number	Spline Info	Notes
F155S, F170S	472KS106X	36 Inv	Contains side gear#029GD104
G155T, G175T	GGAKD101X	36 Inv	Contains side gear# GGAGD110, replaces kit GGAKD100X
G185S	GGAKD102X	39 Inv	Contains side gear#GGAGD111
J175S	472KS107X	36 Inv	Contains side gear#042GD104
G340S, J190, J210S, J340S, J380S, N190S, N210S, N340 (forward and rear axles)	472KS108X	39 Inv	Contains side gear#R44GD103
G380S, J220S, J230SB, J400S (forward and rear axles)	047KR100X	20 Str	Contains side gear#047GD106
	472KS109X	41 Inv	Contains side gear#047GD105
	047KR101X-NLA	39 Inv	NLA in 2004; Contained side gear#047GD103
M220T, M230T	MJAKD103X	41 Inv	Contains side gear#MJAGD114, replaces kit MJAKD100X
M185T, M190T, M210T	MJAKD101X	39 Inv	Contains side gear#MJAGD115, replaces kit MJAKD100X
W230S, W460S (forward and rear axles)	472KS110X	46 Inv	Contains side gear#057GD103
	057KR100X-NLA	22 Str	NLA in 1999; contains side gear #057GD102
S230S/SL, S230SB, S260SB	300KR100X	46 Inv	Contains side gear#300GD101
13802, 15200, 15300, 15040T/P	114467	34 Inv	Contains side gear#110522
16120, 16244, 16344	114242	36 Inv	Contains side gear#110524
16220, 16320	102739	16 Str	Contains side gear#102497
	102740	16 Ang	Contains side gear#102498
16247 (mack mid-liner)	111575	30 Inv	Contains side gear#102499
19050T/P	121748	36 Inv	Contains side gear#126000
19055S/D, 21065S/D, 22065S/D	114469	39 Inv	Contains side gear#110525
	114470	41 Inv	Contains side gear#110527

Wheel Differential Kits (less Side Gears)

Spicer Model	Spicer Part Number
15040S/T/P	118746
19050S/T/P	121749
19055S/D/T/P, 21065S/D/T/P, 22065S/D/T/P	118748

Miscellaneous Axle Kits

Spicer Model	Spicer Part Number	Description
G155T, G175T	GGAKD103X	Parts kit for converting 2-Speeds to Single Speed
M190T, M210T, M220T	MJAKD104X	Parts kit for converting 2-Speeds to Single Speed
J340, J380, J400	472KS102X	IAD assy
S400S	512865	Helical gear retrofit kit
G155T, G175T	GGAKP101X	Sun gear parts kit
M190T, M210T, M220T	MJAKP100X	Sun gear parts kit

Axle Shafts

FEATURES:

- All Spicer axle shafts are made to the same genuine original production specifications
- All shafts made from high grade steel that includes Dana's exclusive inductalloy hardening process
- More flexible, reliable, and more shock resistant than non-genuine shafts:

16 & 19 Spline

Part #	BODY		SPLINE		FLANGE				Notes
	Length	Diameter	Length	O.D.	O.D.	BoltCircles	# of Holes	Hole Type	
58975	38.44	1.69	16 STR / 4" spline	1.88	6.22	5.31	8	.781 TPR	
56981	40.13	1.87	16 STR / 4" spline	2.13	8.50	7	8	.773 STR	
62166	41.31	1.87	16 STR / 4" spline	2.13	8.50	7	8	.948 TPR	
76917	41.31	1.87	16 STR / 4" spline	2.13	8.50	7	8	.635 STR	
109389R1	40.69	1.85	16 STR / 4" spline	1.98	6.62	5.50	8	.635 STR	
175394R1	43.09	1.85	16 STR / 4" spline	1.98	6.62	5.50	8	.635 STR	
175395R1	38.09	1.85	16 STR / 4" spline	1.98	6.62	5.50	8	.635 STR	
455460C1	38.66	1.57	16 STR / 4" spline	1.73	6.19	5.22	8	.574 STR	D135 Model
455461C2	39.50	1.73	16 STR / 4" spline	1.85	6.19	5.22	8	.574 STR	F170 Model
455462C1	38.63	1.57	16 STR / 4" spline	1.73	6.19	5.22	6	.663 STR	
171628R2	39.44	1.57	16 STR / 4" spline	1.85	6.25	5.22	6	.635 STR	
455463C2	39.44	1.73	16 STR / 4" spline	1.85	6.19	5.22	8	.574 STR	
62165	41.31	1.81	16 STR / 4" spline	1.98	6.13	5.25	12	.748 TPR	
65360	38.22	1.61	19 ANG / 4" spline	1.78	6.13	5.13	8	.720 TPR	

22 Spline

Part #	BODY		SPLINE		FLANGE				Notes
	Length	Diameter	Length	O.D.	O.D.	Bolts Circles	# of Holes	Hole Type	
161087R2	39.00	2.00	4	2.10	8.38	7	8	.768 STR	
127803	41.06	2.00	4	2.30	8.50	7	8	.948 TPR	

33 Spline

Part #	BODY		SPLINE		FLANGE				Notes
	Length	Diameter	Length	O.D.	O.D.	Bolt Circles	# of Holes	Hole Type	
91133	41.38	2.06	4	2.125	8.50	7	8	.635 STR	
113334	40.75	2.06	4	2.125	8.50	7	8	.773 STR	
99407	41.22	2.06	4	2.125	8.50	7	8	.635 STR	
113615	46.156	2.06	4	2.125	8.50	7	8	.948 TPR	
126160	41.38	2.06	4	2.125	8.50	7	8	.948 TPR	

34 Spline

Part #	BODY		SPLINE		FLANGE				Notes
	Length	Diameter	Length	O.D.	O.D.	Bolt Circles	# of Holes	Hole Type	
111544	38.84	1.61	4	1.75	6.22	5.31	8	.781 TPR	
118866	38.22	1.61	4	1.75	6.22	5.31	8	.781 TPR	
110880	38.22	1.61	4	1.75	6.12	5.13	8	.720 TPR	
119592	38.50	1.61	4	1.75	6.19	5.22	8	.566 STR	
128112	40.34	1.61	4	1.75	6.22	5.31	8	.781 TPR	

36 Spline

Part #	BODY		SPLINE		FLANGE				Notes
	Length	Diameter	Length	O.D.	O.D.	Bolt Circles	# of Holes	Hole Type	
110881	38.44	1.69	3.5	1.85	6.22	5.31	8	.781 TPR	
110889	40.88	2.06	4	2.313	8.50	7	8	.635 STR	
110890	41.06	2.06	4	2.313	8.50	7	8	.948 TPR	replaced 119639
111545	38.68	1.69	3.5	1.85	6.22	6.22	8	.781 TPR	
113645	40.56	1.69	3.5	1.85	6.22	5.25	12	.781 TPR	
119409	42.75	2.25	4	2.31	8.50	7	8	.948 TPR	
119593	39.50	1.69	3.5	1.85	6.22	5.22	8	.566 STR	
119596	40.75	2.06	4	2.31	8.50	7	8	.773 STR	
126195	42.25	2.25	4	2.31	8.50	7	8	.948 TPR	
126601	42.25	2.25	4	2.31	8.50	7	8	.635 STR	
126804	42.75	2.25	4	2.31	8.50	7.24	8	.948 TPR	
126878	40.00	2.06	4	2.31	8.50	7	8	.948 TPR	
126965	41.31	2.25	4	2.31	8.50	7	8	.948 TPR	
126967	41.31	2.25	4	2.31	8.50	7	8	.635 STR	

36 Spline

Part #	BODY		SPLINE		FLANGE				Notes
	Length	Diameter	Length	O.D.	O.D.	Bolt Circles	# of Holes	Hole Type	
128055	40.60	2.06	4	2.31	8.50	7	8	.773 STR	
128375	40.91	1.75	4	1.85	6.12	5.25	12	.748 TPR	
128438	39.76	2.25	4	2.31	8.50	7	8	.773 STR	
128440	40.56	2.25	4	2.31	8.50	7	8	.948 TPR	
128549	40.56	2.25	11.5	2.31	8.50	7	8	.635 STR	
128553	40.00	2.25	4	2.31	8.50	7	8	.635 STR	
129138	41.38	2.06	11	2.31	8.50	7	8	.948 TPR	
129139	41.38	2.06	11	2.31	8.50	7	8	.635 STR	
129421	44.25	2.25	11.5	2.31	8.50	7	8	.635 STR	
129507	41.38	2.06	4	2.31	8.50	7	8	.948 TPR	replaced 110885
129508	41.38	2.06	4	2.31	8.50	7	8	.635 STR	replaced 111013
129516	41.31	2.25	11.5	2.31	8.50	7	8	.773 STR	
210654	40.91	1.81	4.0	1.85	6.12	5.25	12	.781 TPR	
175SR102	40.25	1.73	4	1.81	6.62	5.50	8	.650 STR	
360SR104-1	38.62	1.73	4	1.81	6.19	5.22	8	.590 STR	
360SR108	40.44	1.73	4	1.81	6.08	5.22	8	.485 STR	
360SR109	10.00	1.73	4	1.81	6.22	5.31	8	.773 TPR	

39 Spline

Part #	BODY		SPLINE		FLANGE				Notes
	Length	Diameter	Length	O.D.	O.D.	Bolt Circles	# of Holes	Hole Type	
108551	41.75	2.25	4	2.50	8.50	7	8	.948 TPR	
108552	43.75	2.25	4	2.50	8.50	7	8	.948 TPR	
110882	40.91	1.81	4	2.00	6.13	5.25	12	.781 TPR	
110886	41.31	1.81	4	2.00	6.13	5.25	12	.748 TPR	
119594	40.91	1.81	4	2.00	6.63	5.50	8	.635 STR	
119927	40.91	1.81	4	2.00	6.13	5.25	12	.748 TPR	
130911	42.88	1.81	4	2.00	6.63	5.50	8	.645 STR	replaced 129322
130912	38.69	1.81	4	2.00	6.63	5.50	8	.645 STR	replaced 129323
578777C2	38.09	1.85	4	2.09	6.19	5.50	8	.650 STR	

41 Spline

Part #	BODY		SPLINE		FLANGE				Notes
	Length	Diameter	Length	O.D.	O.D.	Bolt Circles	# of Holes	Hole Type	
110888	41.31	1.87	4	2.10	8.50	7	8	.635 STR	
126877	40.63	1.87	4	2.10	8.50	7	8	.948 TPR	
127437	38.98	1.87	4	2.10	8.50	7	8	.635 STR	replaced 129752
127438	43.31	1.87	4	2.10	8.50	7	8	.635 STR	replaced 129753
128435	43.31	1.87	11	2.10	8.50	7	8	.635 STR	
128514	38.13	1.87	4	2.10	8.50	7	8	.773 STR	
128515	42.46	1.87	4	2.10	8.50	7	8	.773 STR	
128516	38.98	1.87	4	2.10	8.50	7	8	.948 TPR	
128517	43.31	1.87	4	2.10	8.50	7	8	.948 TPR	
128521	38.13	1.87	4	2.10	8.50	7	8	.948 TPR	
128522	42.46	1.87	4	2.10	8.50	7	8	.948 TPR	
128559	42.46	1.87	11	2.10	8.50	7	8	.773 STR	
128561	43.31	1.87	11	2.10	8.50	7	8	.773 STR	
128563	42.46	1.87	11	2.10	8.50	7	8	.948 TPR	
129330	41.50	1.87	4	2.10	8.50	7	8	.948 TPR	
129332	40.69	1.87	4	2.10	8.50	7	8	.773 STR	replaced 577506C1

Service Carriers

FEATURES:

- 100% genuine Spicer parts used in every assembly, including premium gearing, bearings, and seals
- Latest engineered product upgrades used in every assembly
- Cost competitive with reman pricing
- No core return charges

Spicer Legacy Models

Model	Spicer Part #	Axle Spline	Ratio	Side Gear Part #
19055D Single Carrier w/ Differential Lock	675624	39 Involute	7.17	110525
21065S/22065S	675516	41 Involute	3.08	110527
	674766	41 Involute	3.36	110527
	NLA	41 Involute	3.55	110527
	675323	41 Involute	3.70	110527
	674767	41 Involute	3.90	110527
	674768	41 Involute	4.11	110527
	674769	41 Involute	4.33	110527
	674770	41 Involute	4.63	110527
	674771	41 Involute	4.88	110527
	674772	41 Involute	5.29	110527
	674773	41 Involute	5.57	110527
	675559	41 Involute	5.83	110527
	674909	41 Involute	6.17	110527
	674774	41 Involute	6.50	110527
674775	41 Involute	7.17	110527	
21065S NS	213459	41 Involute	6.17	No Spin Differential
21065D/22065D Single Carrier w/ Differential Lock	675386	41 Involute	3.90	110527
	675538	41 Involute	4.11	110527
	675228	41 Involute	4.88	110527
	675877	41 Involute	5.29	110527
	675269	41 Involute	6.17	110527
	675371	41 Involute	7.17	110527
21065P 22065P	675640	41 Involute	9.77	110527

F Series

Model	Spicer Part #	Axle Spline	Ratio	Side Gear Part #
F155S/F170S	029CA104 5X	36 Involute	4.33	029GD104
	029CA104 7X	36 Involute	4.56	029GD104
	029CA104 1X	36 Involute	4.78	029GD104
	029CA104 2X	36 Involute	5.57	029GD104
	029CA104 3X	36 Involute	6.50	029GD104
	029CA104 4X	36 Involute	7.17	029GD104
F170SN	029CA105 1X	36 Involute	4.78	No Spin Differential
	029CA105 5X	36 Involute	4.33	029GD104

G Series

Model	Spicer Part #	Axle Spline	Ratio	Side Gear Part #
G190S	GGACA134 1X	39 Involute	4.56	GGAGD105
	GGACA134 3X	39 Involute	5.57	GGAGD105
	GGACA134 4X	39 Involute	6.17	GGAGD105
	GGACA134 6X	39 Involute	7.17	GGAGD105
G175T - Two Speed	GGACA128 31X	36 Involute	4.56	GGAGD104
	GGACA128 23X	36 Involute	4.89	GGAGD104
	GGACA128 17X	36 Involute	5.57	GGAGD104
	GGACA128 18X	36 Involute	6.17	GGAGD104
	GGACA128 19X	36 Involute	6.50	GGAGD104

J Series

Model	Spicer Part #	Axle Spline	Ratio	Side Gear Part #
J190S/J210S	R44CA103 1X	39 Involute	3.54	R44GD103
	R44CA103 2X	39 Involute	3.73	R44GD103
	R44CA103 11X	39 Involute	3.91	R44GD103
	R44CA103 3X	39 Involute	4.10	R44GD103
	R44CA103 4X	39 Involute	4.44	R44GD103
	R44CA103 5X	39 Involute	4.78	R44GD103
	R44CA103 6X	39 Involute	5.38	R44GD103
	R44CA103 13X	39 Involute	5.63	R44GD103
	R44CA103 7X	39 Involute	6.14	R44GD103
	R44CA103 8X	39 Involute	6.57	R44GD103

J Series

Model	Spicer Part #	Axle Spline	Ratio	Side Gear Part #
J190S/J210S (continued)	R44CA103 9X	39 Involute	7.17	R44GD103
	R44CA103 10X	39 Involute	8.17	R44GD103
J220S (Note: J220S is the Rear-Rear of the tandem J400S model)	047CA107 1X	41 Involute	3.54	047GD105
	047CA107 2X	41 Involute	3.73	047GD105
	047CA107 3X	41 Involute	3.91	047GD105
	047CA107 4X	41 Involute	4.10	047GD105
	047CA107 5X	41 Involute	4.44	047GD105
	047CA107 6X	41 Involute	4.78	047GD105
	047CA107 12X	41 Involute	5.11	047GD105
	047CA107 7X	41 Involute	5.38	047GD105
	047CA107 13X	41 Involute	5.63	047GD105
	047CA107 8X	41 Involute	6.14	047GD105
	047CA107 9X	41 Involute	6.57	047GD105
	047CA107 10X	41 Involute	7.17	047GD105
	047CA107 11X	41 Involute	8.17	047GD105
J220NS	047CA108 3X	41 Involute	3.91	No Spin Differential
	047CA108 4X	41 Involute	4.10	No Spin Differential
	047CA108 5X	41 Involute	4.44	No Spin Differential
	047CA108 6X	41 Involute	4.78	No Spin Differential
	047CA108 12X	41 Involute	5.11	No Spin Differential
	047CA108 7X	41 Involute	5.38	No Spin Differential
	047CA108 11X	41 Involute	5.63	No Spin Differential
J400S Forward Carrier (Note 1)	472CA112 1X	41 Involute	3.54	047GD105
	472CA112 2X	41 Involute	3.73	047GD105
	472CA112 3X	41 Involute	3.91	047GD105
	472CA112 4X	41 Involute	4.10	047GD105
	472CA112 5X	41 Involute	4.44	047GD105
	472CA112 6X	41 Involute	4.78	047GD105
	472CA112 12X	41 Involute	5.11	047GD105
	472CA112 7X	41 Involute	5.38	047GD105
	472CA112 11X	41 Involute	5.63	047GD105
	472CA112 8X	41 Involute	6.14	047GD105

J Series

Model	Spicer Part #	Axle Spline	Ratio	Side Gear Part #
J400S Forward Carrier (cont) - (Note 1)	472CA112 9X	41 Involute	6.57	047GD105
	472CA112 10X	41 Involute	7.17	047GD105
Note 1: J400S Forward Carrier part numbers "472CA115" are replaced by the 472CA112 carriers.				

M Series

Model	Spicer Part #	Axle Spline	Ratio	Side Gear Part #
M190T	MJACA122 54X	39 Involute	3.70	MJAGD115
	MJACA122 71X	39 Involute	3.90	MJAGD115
	MJACA122 53X	39 Involute	4.11	MJAGD115
	MJACA122 37X	39 Involute	4.56	MJAGD115
	MJACA122 23X	39 Involute	4.89	MJAGD115
	MJACA122 38X	39 Involute	5.29	MJAGD115
	MJACA122 1X	39 Involute	5.57	MJAGD115
	MJACA122 2X	39 Involute	6.14	MJAGD115
	MJACA122 3X	39 Involute	6.50	MJAGD115
	MJACA122 4X	39 Involute	7.17	MJAGD115
M190T NS	MJACA123 25X	39 Involute	5.29	No Spin Differential
M220S	MJACA129 2X	41 Involute	3.90	MJAGD112
	MJACA129 4X	41 Involute	4.56	MJAGD112
	MJACA129 7X	41 Involute	5.57	MJAGD112
M220T	MJACA127 45X	41 Involute	3.70	MJAGD112
	MJACA127 62X	41 Involute	3.90	MJAGD112
	MJACA127 57X	41 Involute	4.11	MJAGD112
	MJACA127 26X	41 Involute	4.56	MJAGD112
	MJACA127 22X	41 Involute	4.89	MJAGD112
	MJACA127 27X	41 Involute	5.29	MJAGD112
	MJACA127 1X	41 Involute	5.57	MJAGD112
	MJACA127 2X	41 Involute	6.14	MJAGD112
	MJACA127 3X	41 Involute	6.50	MJAGD112
	MJACA127 4X	41 Involute	7.17	MJAGD112
M220T NS	MJACA126 12X	41 Involute	3.90	No Spin Differential
	MJACA126 10X	41 Involute	4.56	No Spin Differential
	MJACA126 8X	41 Involute	4.89	No Spin Differential

M Series

Model	Spicer Part #	Axle Spline	Ratio	Side Gear Part #
M220T NS (continued)	MJACA126 9X	41 Involute	5.29	No Spin Differential
	MJACA126 1X	41 Involute	5.57	No Spin Differential
	MJACA126 3X	41 Involute	6.14	No Spin Differential
	MJACA126 2X	41 Involute	6.50	No Spin Differential
	MJACA126 4X	41 Involute	7.17	No Spin Differential
M230T	MJACA134 8X	41 Involute	3.70	MJAGD112
	MJACA134 9X	41 Involute	3.90	MJAGD112
	MJACA134 10X	41 Involute	4.11	MJAGD112
	MJACA134 7X	41 Involute	4.56	MJAGD112
	MJACA134 5X	41 Involute	4.89	MJAGD112
	MJACA134 6X	41 Involute	5.29	MJAGD112
	MJACA134 1X	41 Involute	5.57	MJAGD112
	MJACA134 2X	41 Involute	6.14	MJAGD112
	MJACA134 3X	41 Involute	6.50	MJAGD112
	MJACA134 4X	41 Involute	7.17	MJAGD112

S Series Single Axles

Model	Spicer Part #	Axle Spline	Ratio	Side GearPart #
S230SB	300CA101 6X	46 Involute	3.07	300GD101
	300CA101 1X	46 Involute	3.21	300GD101
	300CA101 7X	46 Involute	3.54	300GD101
	300CA101 2X	46 Involute	3.73	300GD101
	300CA101 8X	46 Involute	3.91	300GD101
	300CA101 9X	46 Involute	4.10	300GD101
	300CA101 4X	46 Involute	4.44	300GD101
	300CA101 5X	46 Involute	4.78	300GD101
	300CA101 10X	46 Involute	5.63	300GD101
	300CA106 1X	46 Involute	5.63	Special Neoplan Bus applications
S230SL Single Axle w/ Differential lock	300CA100 1X	46 Involute	3.07	300GD101
	300CA100 2X	46 Involute	3.21	300GD101
	300CA100 7X	46 Involute	3.54	300GD101
	300CA100 3X	46 Involute	3.73	300GD101
	300CA100 8X	46 Involute	3.91	300GD101

S Series Single Axles

Model	Spicer Part #	Axle Spline	Ratio	Side Gear Part #
S230SL Single Axle w/ Differential lock (continued)	300CA100 9X	46 Involute	4.10	
	300CA100 5X	46 Involute	4.44	
	300CA100 6X	46 Involute	4.78	

S Series Tandem Axles

Model	Spicer Part #	Axle Spline	Ratio	Side Gear Part #
S400S Rear-Rear Carrier	390CA111 1X	41 Involute	2.81	047GD100
	390CA111 2X	41 Involute	2.93	047GD100
	390CA111 3X	41 Involute	3.07	047GD100
	390CA111 4X	41 Involute	3.21	047GD100
	390CA111 5X	41 Involute	3.42	047GD100
	390CA111 11X	41 Involute	3.54	047GD100
	390CA111 6X	41 Involute	3.73	047GD100
	390CA111 7X	41 Involute	3.91	047GD100
	390CA111 8X	41 Involute	4.10	047GD100
	390CA111 9X	41 Involute	4.44	047GD100
S400SN Rear-Rear Carrier	390CA113 7X	41 Involute	3.91	No Spin
S400S Forward Carrier	390CA119 1X	41 Involute	2.81	047GD100
	390CA119 2X	41 Involute	2.93	047GD100
	390CA119 3X	41 Involute	3.07	047GD100
	390CA119 4X	41 Involute	3.21	047GD100
	390CA119 5X	41 Involute	3.42	047GD100
	390CA119 11X	41 Involute	3.54	047GD100
	390CA119 6X	41 Involute	3.73	047GD100
	390CA119 7X	41 Involute	3.91	047GD100
	390CA119 8X	41 Involute	4.10	047GD100
390CA119 9X	41 Involute	4.44	047GD100	

W Series

Model	Spicer Part #	Axle Spline	Ratio	Side Gear Part #
W230S Rear-Rear Carrier	057CA108 1X	46 Involute	3.54	057GD102
	057CA108 2X	46 Involute	3.73	057GD102
	057CA108 3X	46 Involute	3.91	057GD102
	057CA108 4X	46 Involute	4.10	057GD102

W Series

Model	Spicer Part #	Axle Spline	Ratio	Side Gear Part #
W230S Rear-Rear Carrier (continued)	057CA108 5X	46 Involute	4.44	057GD102
	057CA108 6X	46 Involute	4.78	057GD102
	057CA108 7X	46 Involute	5.38	057GD102
	057CA108 8X	46 Involute	6.14	057GD102
	057CA108 9X	46 Involute	6.57	057GD102
	057CA108 10X	46 Involute	7.17	057GD102
	057CA108 11X	46 Involute	5.63	057GD102
W230S Rear-Rear Carrier - Pinion-Up	057CA112 5X	46 Involute	4.44	057GD102
	057CA112 6X	46 Involute	4.78	057GD102
	057CA112 7X	46 Involute	5.38	057GD102
	057CA112 8X	46 Involute	5.63	057GD102
	057CA112 9X	46 Involute	6.14	057GD102
	057CA112 10X	46 Involute	6.57	057GD102
W230SN Rear-Rear Carrier	057CA109 3X	46 Involute	3.91	No Spin Differential
	057CA109 4X	46 Involute	4.10	No Spin Differential
	057CA109 6X	46 Involute	4.78	No Spin Differential
	057CA109 7X	46 Involute	5.38	No Spin Differential
	057CA109 8X	46 Involute	6.14	No Spin Differential
W460S Forward Carrier w/o the Lockout Cylinder Cover	474CA113 1X	46 Involute	3.54	057GD103
	474CA113 2X	46 Involute	3.73	057GD103
	474CA113 3X	46 Involute	3.91	057GD103
	474CA113 4X	46 Involute	4.10	057GD103
	474CA113 5X	46 Involute	4.44	057GD103
	474CA113 6X	46 Involute	4.78	057GD103
	474CA113 7X	46 Involute	5.38	057GD103
	474CA113 8X	46 Involute	6.14	057GD103
	474CA113 9X	46 Involute	6.57	057GD103
	474CA113 10X	46 Involute	7.17	057GD103

SPICER[®]

Drivetrain Products

**Dana Corporation
Heavy Vehicle Technologies
and Systems Service**

PO Box 321
Toledo, Ohio 43697-0321
1-800-SAY-DANA (729-3262)
www.dana.com
www2.dana.com/expert

**Dana Corporation
Heavy Vehicle Technologies
and Systems Service - Canada**

5095 South Service Road
Beamsville, Ontario LOR 1B0
Tech Service: (905) 563-4991

**Dana Corporation
Heavy Vehicle Technologies and
Systems Service - International**

(419) 861-6325
(800) 621-8084
www.spicerparts.com

